

LEGEND

- = INDICATES JURISDICTION OF NEW JERSEY DEPARTMENT OF TRANSPORTATION
- = INDICATES JURISDICTION OF MUNICIPALITY (Within Municipal Limits)
- = INDICATES EXISTING ROADWAYS NOT AFFECTED BY STATE'S CONSTRUCTION, TO REMAIN JURISDICTION OF RESPECTIVE LOCAL GOVERNMENTAL AGENCIES.

New Jersey
Department Of Transportation
ROUTE I 80 SECTION 5S
JURISDICTIONAL LIMIT MAP
Green Street To River Street
Township of South Hackensack County of Bergen
City of Hackensack
Scale: 1" = 100'
January 1971

1772

80-7A 1773

PLAN SCALE 1" = 100'

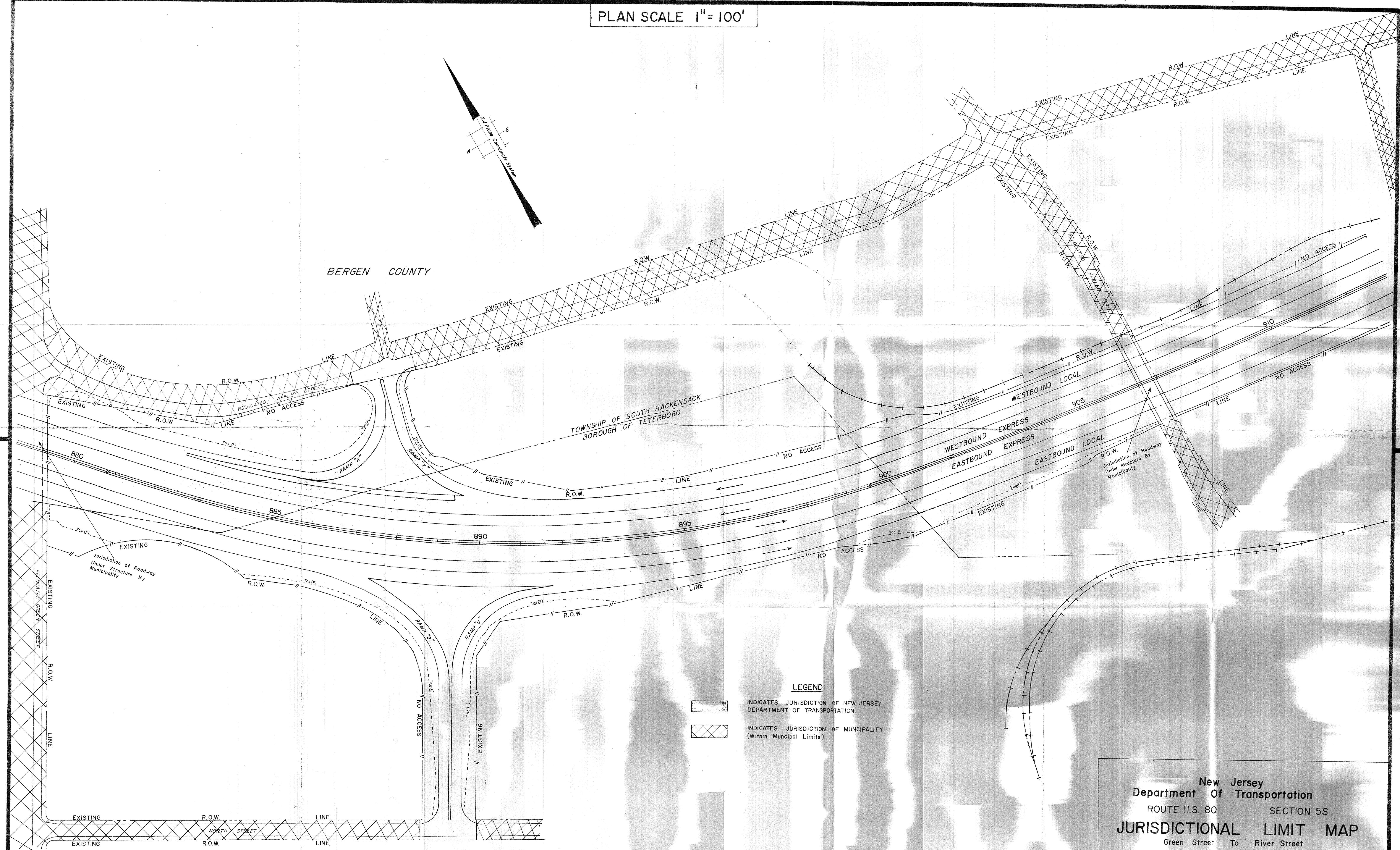
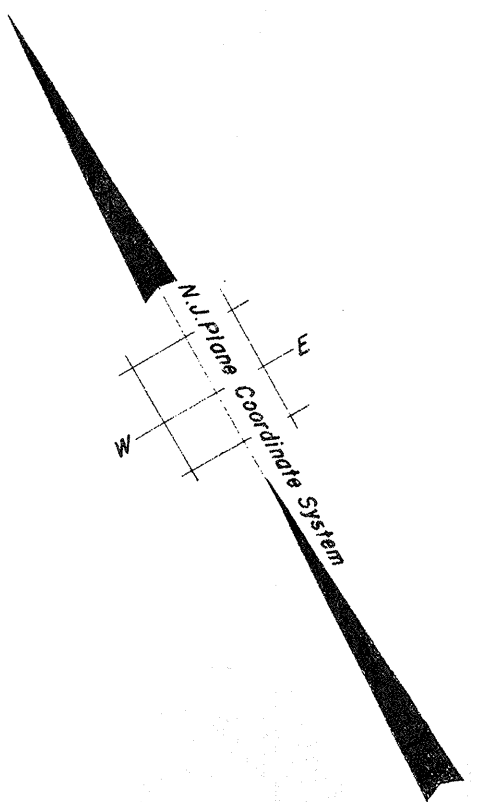

- LEGEND**
- INDICATES JURISDICTION OF NEW JERSEY DEPARTMENT OF TRANSPORTATION
 - INDICATES JURISDICTION OF MUNICIPALITY (Within Muncpal Limits)

New Jersey
Department of Transportation
ROUTE U.S. 80 SECTION 5S
JURISDICTIONAL LIMIT MAP
Green Street To River Street
Township of South Hackensack
Borough of Teterboro
Scale 1" = 100'
County of Bergen
November 1970
map-176